



# K10 POLYURETHANE (PU)

## LIQUID APPLIED, MOISTURE CURING ELASTOMERIC MEMBRANE



**LIQUID APPLIED**



**FLEXIBLE**

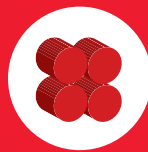

**HIGH SOLID CONTENT**

### DESCRIPTION

Davco K10 Polyurethane (PU) is a concealed liquid applied polyurethane elastomeric seamless waterproofing membrane. Moisture-cured characteristics ensures that further works can be carried out at a shorter time once the membrane has dried out.

### USES

All types of roofs, balconies and decks.

Retaining walls and basements.

Waterproofing, repair and rust protection for gutters, troughs and tanks.

Waterproofing and protection of parapet walls and flashings.

Waterproofing of planter boxes.

Waterproofing of external areas such as suspended structures.

Damp-proofing of sandwich slabs, above and below grade.

Tanking.

Sealing of joints.

Lining faulty gutters and downpipes.

Eliminates soldering of cracked non-ferrous roof valleys and flashings.

### ADVANTAGES

- Liquid applied
- Easy to apply
- High solid content
- Rapid curing
- Flexible
- Seamless application

### TECHNICAL DATA

Thickness of film	min. 0.8mm
Specific gravity	1.2 ± 0.05
Solid Content	> 80%
Tensile Strength	> 1.5 N/mm <sup>2</sup>
Elongation at break	> 500%
Shore A hardness	46
Water vapor transmission	7.57 g/m <sup>2</sup> / 24 hrs
Resistance to water penetration (0.6 bar for 6 hours)	0
Adhesion to substrate	> 1 N/mm <sup>2</sup>
Crack Bridging	No crack @ 4mm width  No crack after 10 cycles of closing and stretching to 1mm

Specifications are subject to change without notification. Results shown are typical but reflect test procedures used. Actual field performance will depend on installation methods and site conditions.



**BUILDING TRUST**





# K10 POLYURETHANE (PU)

## APPLICATION

All surfaces to be treated must be as clean and dry as possible. It may be necessary to wire brush areas where dirt or scale cannot be removed, with a stiff broom. Moisture content should not be at the saturated zone.

Check surface for cracks, splits, flashing, coverings, etc. Where cracks exceed 1 mm, they must be filled with fabric matting, followed by a liberal application of Davco K10 Polyurethane (PU).

For reduction in blistering and better adhesion to concrete substrate, prime area with Davco GRS Primer prior to application.

Davco K10 Polyurethane (PU) should be applied directly from the pail.

Apply one coat of Davco K10 Polyurethane (PU) to the whole area and allow to cure, approx. 6-10 hours. (Temperature dependent)

Apply the 2nd coat in a perpendicular direction to the 1st coat.

All joints in floors should preferably be treated with additional coat of Davco K10 Polyurethane (PU).

Davco K10 Polyurethane (PU) can be applied by brush or roller. Normally a minimum of 2 coats is required, unless a trowel method of application is adopted.

Where Davco K10 Polyurethane (PU) has to be applied to above a height of 500mm from the floor level, a wire mesh is recommended to be fixed prior to applying the protective render to prevent cracking and to improve adhesion.

Ponding should be carried out at least 48 hours after the final application of Davco K10 Polyurethane (PU).

Davco Polyurethane (PU) is not to be used as a trafficable top coat and is not resistant to permanent UV exposure and weathering.

## COVERAGE

Recommended coverage approximately 20m<sup>2</sup> / pail / 0.8mm (WFT) per 2 coats.

## PACKAGING

20 kg pail

## SHELF LIFE

Shelf life up to 12 months in unopened containers when stored in a cool dry place.

## HEALTH & SAFETY

In case of eye splashes or excessive skin contact, thoroughly flush with clean water. If ill effects occur, seek medical attention immediately. Refer to safety data sheet.

### Disclaimer

The use of this product is beyond the manufacturer's control and liability is restricted to the replacement of material proven faulty. The manufacturer is not responsible for any loss or damage arising from incorrect usage. Specifications are subjected to changes without prior notice. Before application, customers and users are requested to check that they have the latest version of this document from our website [www.sika.com.sg](http://www.sika.com.sg)

## LARGE ROOF AND FLASHING DETAIL

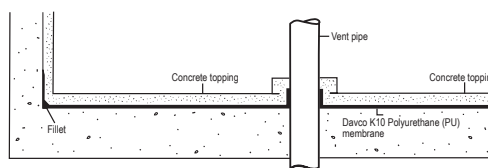

## SECTION THROUGH A TYPICAL SHOWER RECESS

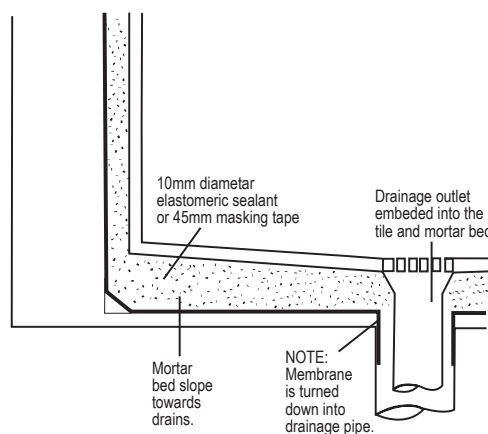

## Sika (Singapore) Pte Ltd.

28 Tuas South Avenue 8 Singapore 637648

Tel: (65) 6861 0632 • Fax: (65) 6862 1172

Email: [sales@sg.sika.com](mailto:sales@sg.sika.com)

Website: [www.sika.com.sg](http://www.sika.com.sg)

Online Store: [davco-online.com.sg](http://davco-online.com.sg)



Certificate SG09/02195



Certificate SG95/06111



Certificate SG09/00175



Certificate GMS-C / GHG / 0002

